

GLASSWARE

- Glassware set includes one 1,000ml evaporating flask and one 1,000ml receiving flask
- Evaporating flasks and vapor tube come standard with 29/32 joint size and are also available with 24/29 ground joints
- Ventilation cap without ground joints for easy handling and grease-free operation included
- A venting valve with refill function is optionally available
- G3/G3 XL or G6 glassware required for using DAA on Hei-VAP Expert/Ultimate Control models
- All glassware also available with transparent plastic coating (for temperature ranges up to max. 80 °C)

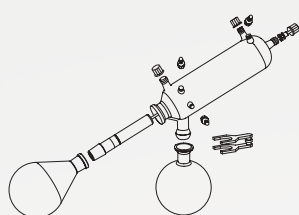

G1

Glassware set G1

Diagonal condenser for all standard distillations; the option with the most affordable price

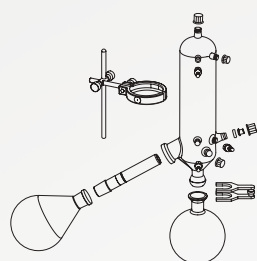

G3

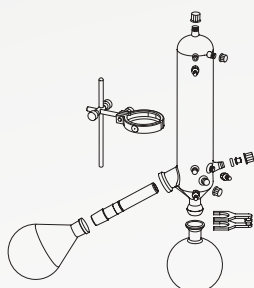

G3 XL

Glassware set G3

Vertical condenser for all standard distillations; the option with the smallest space requirements

Glassware set G3 XL

Up to 40 % higher evaporation rate thanks to 2,200 cm² of cooling surface

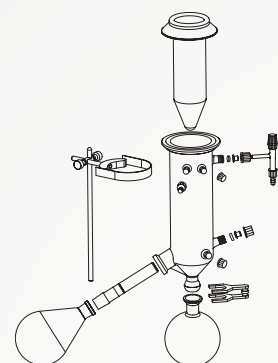

G5

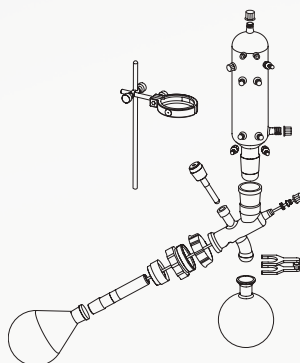

G6

Glassware set G5

Dry ice condenser for low-boiling solvents

Glassware set G6

Vertical condenser; centerpiece with valve for reflux distillation

Evaporation rate ¹	Toluene	Acetone	Ethanol	Isopropanol	Water
G3 Vertical	6.5 l/h	6.0 l/h	2.5 l/h	4.0 l/h	1.4 l/h
G3 XL-Vertical	8.5 l/h	7.5 l/h	3.5 l/h	4.9 l/h	1.4 l/h
Improvement with XL-Condenser	31 %	25 %	40 %	23 %	system limit reached with 1.4 l/h

¹ With maximum condenser efficiency